

# MASTER LAYOUT PLAN (AMENDED) OF ATAL BIHARI VAJPAYEE ZOOLOGICAL PARK IN BILIKAL WEST RESERVE FOREST AREA NEAR KAMLAPUR, HOSPET TALUK, BELLARY (DIST) KARNATAKA.

(RELOCATION OF EXISTING MINI ZOO FROM BELLARY)

SCALE = 1:5000

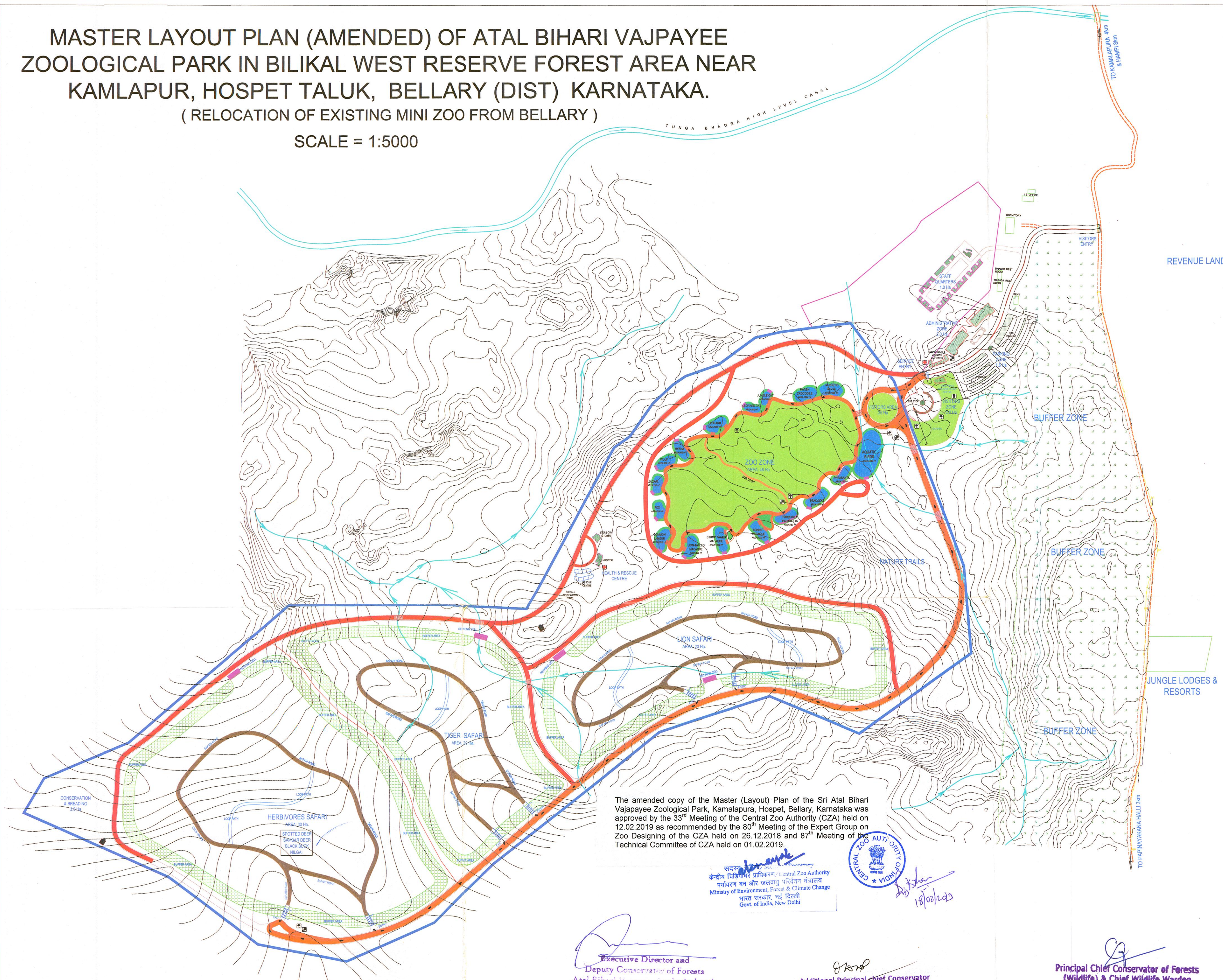

The amended copy of the Master (Layout) Plan of the Sri Atal Bihari Vajpayee Zoological Park, Kamalapur, Hospet, Bellary, Karnataka was approved by the 33<sup>rd</sup> Meeting of the Central Zoo Authority (CZA) held on 12.02.2019 as recommended by the 80<sup>th</sup> Meeting of the Expert Group on Zoo Designing of the CZA held on 26.12.2018 and 87<sup>th</sup> Meeting of the Technical Committee of CZA held on 01.02.2019.

सरकार भारत  
केन्द्रीय विज्ञान प्रौद्योगिकी विभाग  
मंत्रालय पर्यावरण, वन और प्रकृतिक परिवर्तन  
Ministry of Environment, Forest & Climate Change  
भारत सरकार, नई दिल्ली  
Govt. of India, New Delhi

13/02/2019

*[Signature]*  
Executive Director and  
Deputy Conservator of Forests  
Atal Bihari Vajpayee Zoological park  
Kamalapur, Hospet Tal. Bellary Dist

*[Signature]*  
Additional Principal Chief Conservator  
of Forests and Member Secretary,  
Zoo Authority of Karnataka, Mysore

*[Signature]*  
Principal Chief Conservator of Forests  
(Wildlife) & Chief Wildlife Warden  
Karnataka, Bengaluru.

NOTES:-  
- ALL DIMENSIONS ARE IN METERS  
- THIS DRAWING IS A COPYRIGHT AND PROPERTY OF THE CONSULTANT, IS NOT TO BE PRODUCED, COPIED, HANDED OVER TO THIRD PARTY OR USED FOR ANY OTHER PURPOSE OTHER THAN FOR WHICH IT IS INTENDED.  
- ALL DIMENSIONS SHALL BE VERIFIED ON SITE PRIOR TO START OF WORK. ANY DISCREPANCY SHALL BE BROUGHT TO THE NOTICE OF THE CONSULTANT.  
- THE CONSTRUCTION MANAGER/CONTRACTOR MUST CHECK ALL DIMENSIONS AND DETAILS AND BE RESPONSIBLE FOR THE SAME. ANY DISCREPANCY SHALL BE BROUGHT TO THE NOTICE OF THE ARCHITECT.  
- THIS DRAWING IS TO BE READ AND NOT SCALED.  
- THIS DRAWING SHALL BE READ IN CONJUNCTION WITH ALL RELEVANT ARCHITECTURAL, STRUCTURAL AND SERVICES DRAWINGS. ANY DISCREPANCY NOTICED SHALL BE BROUGHT TO THE ATTENTION OF THE CONSULTANTS  
- DRAWING APPROVAL IS FOR THE CONFORMITY WITH OUTLINE DESIGN INTENT ONLY AND DOES NOT RELIEVE THE PROJECT MANAGERS / CONTRACTORS / SUBCONTRACTORS FROM FULL RESPONSIBILITY FOR THE ACCURACY, INTEGRATION AND FITNESS FOR PURPOSE OF DESIGN

AREA	
TOTAL AREA	= 141.6 Ha
ZOO ZONE	48.0 Ha
SAFARI ZONE	70.0 Ha
CONSERVATION & BREEDING	3.0 Ha
OTHERS	13.4 Ha
VISITORS ZONE	2.8 Ha
ADMINISTRATIVE ZONE	2.0 Ha
STAFF QUARTERS	1.0 Ha
PARKING ZONE	1.6 Ha

LEGEND	
	BOUNDARY
	CONTOUR
	VISITORS ROAD
	SERVICE ROAD
	SAFARI ROAD
	APPROACH ROAD
	NEW ENCLOSURES
	BUFFER AREA
	BUFFER ZONE
	CULVERT
	NALLA
	BUILDINGS
	RETIRING AREA
	LANDSCAPED AREA
	TUNGABHADRA CANAL
	WILD LIFE AREA
	DOUBLE GATE ENTRY SYSTEM
	VIEWING AREA
	MOAT
	HOSPITAL & FIRST AID
	RESTAURANTS
	TOILETS
	SHELTERS

CLIENT :  
KARNATAKA FOREST DEPARTMENT, BELLARY.

PROJECT :  
ATAL BIHARI VAJPAYEE ZOOLOGICAL PARK, HOSPET TALUK, BELLARY (DIST) KARNATAKA.

TITLE :  
MASTER LAYOUT PLAN AMENDED

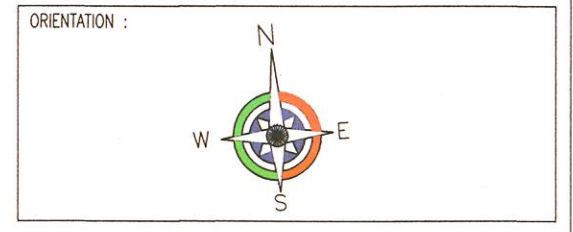

SCALE: 1:5000  
R. DATE: 30-05-2018

DAROLI SLOTH BEAR SANCTUARY APPROXIMATELY 2 KM FROM PAKKALAHALLI - KAMALAPUR ROAD

JUNGLE LODGES & RESORTS

TO PAPPAYAKKANA HALLI 3km

REVENUE LAND

BUFFER ZONE

BUFFER ZONE

BUFFER ZONE

NATURE TRAILS

TUNGA BHADRA HIGH LEVEL CANAL

TO KAMALAPUR AND HOSPET